

DATA SHEET

SL-4300X series

Low profile compact beacon

sentinel
vehicle lighting



Images



Dimensions

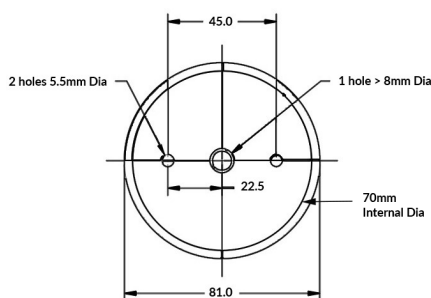
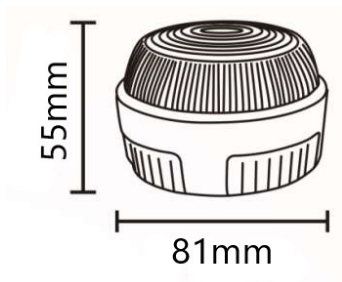

Specifications

Functions:	Low-profile compact beacon Fresnel design on sides and top- providing better illumination for improved visibility
Light source:	LED
LEDs:	20
Lens colour:	Amber, red, blue, white or green
Certifications:	ECE Reg 10
Dimensions:	55 x 81mm
Voltage:	10-110V
IP rating:	IP65
Operating temperature:	-30°C to +65°C
Mounting:	2 bolt base
Wiring:	300mm cable terminated in partially-stripped wires Red = positive Black = negative
Flash patterns:	2 wires (red/black): quad flash
Power rating:	4.68W @ 12V / 4.08W @ 24V
Current draw:	0.39A @ 12Vdc / 0.17A @ 24Vdc
Reverse polarity protection:	Yes
Warranty:	3 years



Materials

Outer lens:	Impact resistant and UV resistant polycarbonate
Base:	ABS

Part numbers

SL-43001	Low profile compact beacon, 2-bolt, amber
SL-43002	Low profile compact beacon, 2-bolt, red
SL-43003	Low profile compact beacon, 2-bolt, blue
SL-43004	Low profile compact beacon, 2-bolt, white
SL-43005	Low profile compact beacon, 2-bolt, green



When beacon is mounted on a metal panel or bracket, the panel or bracket must be connected to earth. If an insulating panel or bracket is used then access to the insulated wires of the beacon must be prevented, either by using an insulating sleeve or by means of a suitable insulating barrier.